



Stonegrove, Edgware, HA8 7UH  
£349,950 Leasehold Council Tax Band E

**REAL ESTATES**  
Est.1981  
Estate Agents · Residential Sales · Investments · Lettings

A highly desirable ground floor two bedroom apartment presented in great condition throughout. This property is located well for both access to Edgware and Stanmore facilities and is an ideal purchase for a first time buyer. Available now.

**Key Features:**

- \*2 bedroom ground floor flat
- \* 2 bathrooms (1ensuite )
- \* Lounge/Dining Room
- \* Communal gardens
- \*Gated Parking
- \* 128 year lease
- \* Service charge £3000pa
- \* Ground rent £450.00



**Mayfair Court, Stonegrove, Edgware, HA8**

Approximate Area = 791 sq ft / 73.5 sq m

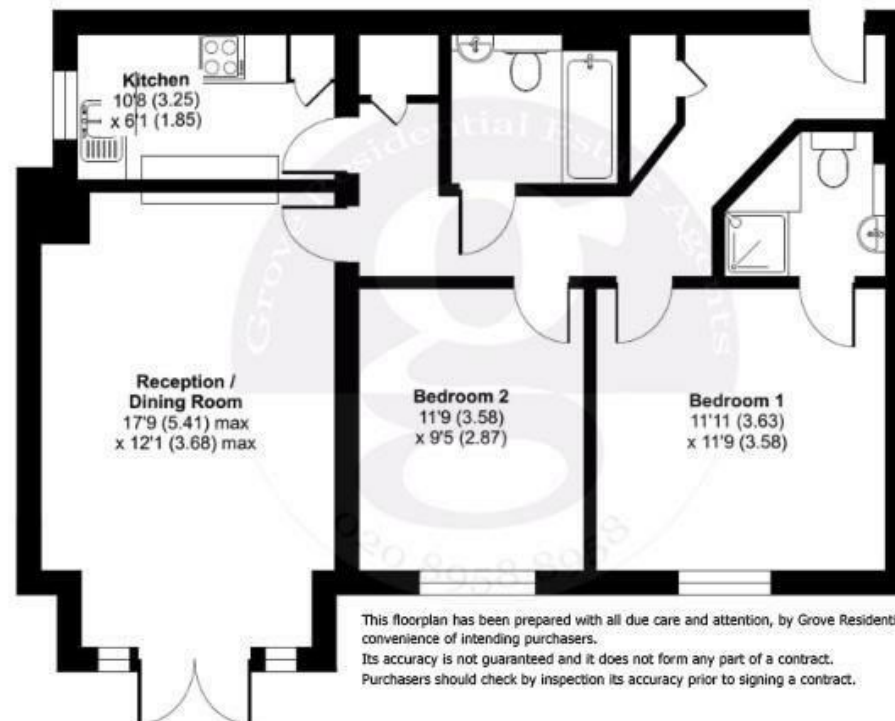

This floorplan has been prepared with all due care and attention, by Grove Residential for the convenience of intending purchasers. Its accuracy is not guaranteed and it does not form any part of a contract. Purchasers should check by inspection its accuracy prior to signing a contract.

